

CERTIFICATE OF SURVEYOR

STATE OF UTAH
 COUNTY OF SALT LAKE } S.S.
 I, CHARLES V. KING, OF SALT LAKE CITY, UTAH, HEREBY CERTIFY THAT THIS PLAT WAS MADE FROM NOTES TAKEN DURING AN ACTUAL SURVEY UNDER MY SUPERVISION AND THAT IT CORRECTLY REPRESENTS STAR VALLEY RANCH PLAT 8, A SUBDIVISION IN PART OF HOMESTEAD ENTRY SURVEY 65, IN THE E 1/2 SEC. 30, T. 35 N., R. 118 W., 6TH PM., LINCOLN COUNTY, WYOMING, AS MARKED ON THE GROUND DURING SAID SURVEY.
 Charles V. King
 LAND SURVEYOR No. 510
 THE FOREGOING INSTRUMENT WAS ACKNOWLEDGED BEFORE ME THIS 23RD DAY OF JULY A.D. 1971. WITNESS MY HAND AND OFFICIAL SEAL:
 C. J. Schuchert
 NOTARY PUBLIC MY COMMISSION EXPIRES 2-23-74

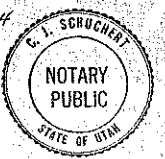

CERTIFICATE OF OWNERS

STATE OF UTAH
 COUNTY OF SALT LAKE } S.S.
 KNOW ALL MEN BY THESE PRESENTS THAT LEISURE VALLEY, INC., A NEVADA CORPORATION, DOES HEREBY CERTIFY THAT THE FOREGOING SUBDIVISION, BEING PART OF HOMESTEAD ENTRY SURVEY 65, STATE OF WYOMING, MORE PARTICULARLY DESCRIBED AS BEGINNING AT THE N.W. COR. LOT 20, STAR VALLEY RANCH PLAT 7, A SUBDIVISION, SAID POINT BEING ON THE WEST LINE OF SAID H.E.S. 65 50°01'14"W 2087.127' FROM COR. 1 H.E.S. 65; THENCE ALONG SAID WEST LINE N0°01'14"E 608.589'; THENCE 562°E 208.244' TO A POINT ON THE ARC OF A 370.00' RADIUS CURVE, THE CENTER OF WHICH BEARS S62°E; THENCE NORTHEASTERLY ALONG THE ARC OF SAID CURVE TO THE RIGHT 400.38' THROUGH A CENTRAL ANGLE OF 62°; THENCE EAST 657.50' TO A POINT OF CURVATURE; THENCE EASTERLY ALONG THE ARC OF A 1078.765' RADIUS CURVE TO THE RIGHT 124.98' THROUGH A CENTRAL ANGLE OF 6°54'13"; THENCE N6°54'13"E 79.495' TO COR. 3, SAID H.E.S. 65; THENCE ALONG THE EASTERLY LINE OF SAID H.E.S. 65 S89°53'10"E 656.007' TO CORNER 4, SAID H.E.S. 65 AND S0°16'45"E 1091.485' TO THE N.E. COR. OF LOT 78, SAID STAR VALLEY RANCH PLAT 7; THENCE ALONG THE NORTHERLY BOUNDARY LINE OF SAID STAR VALLEY RANCH PLAT 7 WEST 340.543', S85°W 79.107', N50°W 518.945', WEST 183.659', SOUTH 5.00', WEST 182.50', SOUTH 20.766', WEST 182.50', NORTH 55.00', WEST 252.50', SOUTH 49.76', WEST 190.00', NORTH 8.410' AND WEST 180.786' TO THE POINT OF BEGINNING, CONTAINING 36.14 ACRES, AS APPEARS ON THIS PLAT IS WITH THE FREE CONSENT AND IN ACCORDANCE WITH THE DESIRES OF THE UNDERSIGNED OWNERS; THAT THE NAME OF THE SUBDIVISION SHALL BE STAR VALLEY RANCH PLAT 8; THAT THE ROADS SHOWN ON THE PLAT ARE HEREBY DEDICATED TO THE PERPETUAL USE OF THE PUBLIC; AND THAT THE SUBDIVISION IS SUBJECT TO THE COVENANTS AND RESTRICTIONS OF RECORD.

LEISURE VALLEY, INC., A NEVADA CORPORATION
 Lloyd B. Wittich, President
 Harold P. Stewart, Sec. Treas.
 THE FOREGOING INSTRUMENT WAS ACKNOWLEDGED BEFORE ME THIS 30TH DAY OF JULY A.D. 1971. WITNESS MY HAND AND OFFICIAL SEAL:
 C. J. Schuchert
 NOTARY PUBLIC MY COMMISSION EXPIRES 2-23-74

Vacated
 Lots 13, 56
 H-180-B

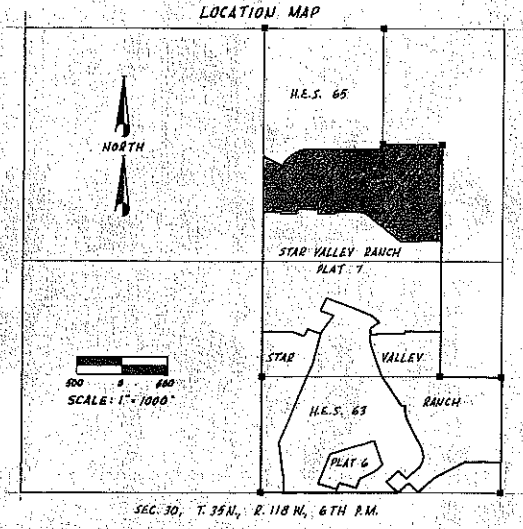

432466A
 RECEIVED
 AUG 4 1971
 Lincoln County Clerk

BASIS OF BEARING
 N0°06'15"W, BEING THE BEARING BETWEEN CORNER 1 AND CORNER 2, HOMESTEAD ENTRY SURVEY 63, STATE OF WYOMING.

NOTES
 A 10' EASEMENT FOR PUBLIC AND PRIVATE UTILITIES IS RESERVED ON ALL SIDE AND REAR LOT LINES.
 FIGURES IN PARENTHESES DENOTE LOT AREA IN ACRES.
 A 1/2" x 18" IRON ROD HAS BEEN SET AT ALL LOT CORNERS.
 * DENOTES THAT A CERTIFIED LAND CORNER RECORDATION CERTIFICATE HAS BEEN FILED.

COUNTY COMMISSION APPROVAL
 PURSUANT TO SECTION 34-114, WYOMING STATUTES, 1957, AS AMENDED, THE FOREGOING STAR VALLEY RANCH PLAT 8 WAS APPROVED BY THE BOARD OF LINCOLN COUNTY COMMISSIONERS THIS 4TH DAY OF AUGUST A.D. 1971.
 [Signatures]
 CHAIRMAN BOARD OF COMMISSIONERS
 LINCOLN COUNTY CLERK
 DEDICATED STREETS WILL NOT BE MAINTAINED BY LINCOLN COUNTY

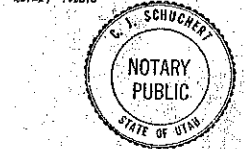

STAR VALLEY RANCH PLAT 8
 IN E 1/2 SEC. 30, T. 35 N., R. 118 W., 6TH PM., BEING PART OF HOMESTEAD ENTRY SURVEY 65, LINCOLN COUNTY, WYOMING.